

PHASED BARE LAND STRATA PLAN OF PART OF LOT A, D. L. 3, 26, 22 AND 23,  
 THETIS ISLAND, COWICHAN DISTRICT, PLAN VIP73316 EXCEPT PART IN  
 STRATA PLAN VIS5168 PHASE 1

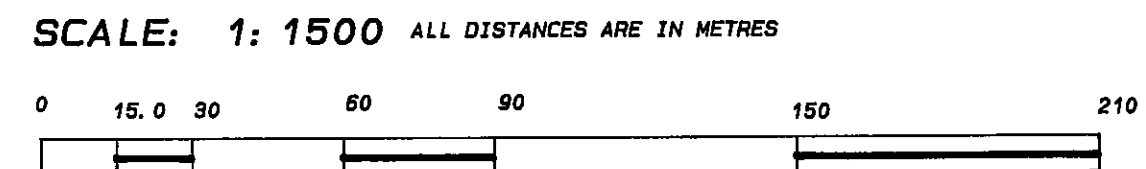

BCGS 92G002 AND 92C092

LEGEND

- BEARINGS ARE ASTRONOMIC AND ARE DERIVED FROM VIP73316
- DENOTES STANDARD IRON POST FOUND
- DENOTES STANDARD IRON POST SET
- ha DENOTES HECTARES
- CP DENOTES COMMON PROPERTY
- DIP DENOTES OLD IRON POST FOUND

PHASE 2 OF 3 PHASES  
 STRATA PLAN VIS5168

DEPOSITED AND REGISTERED IN THE LAND  
 TITLE OFFICE AT VICTORIA, B.C.  
 THIS 16 DAY OF MARCH, 2005

REGISTRAR

APPROVED AS A PHASE BARE LAND STRATA PLAN  
 UNDER THE STRATA PROPERTY ACT THIS 16  
 DAY OF MARCH, 2005.

APPROVING OFFICER, MINISTRY OF TRANSPORTATION

NATURAL BOUNDARY TRAVERSE			
NAL1101 to PNB1112	136° 36' 39"	314.39	
NAL1101 to PNB1114	137° 02' 23"	296.42	
NAL1101 to PNB1115	135° 49' 03"	290.99	
NAL1101 to PNB1116	133° 06' 55"	286.22	
NAL1101 to PNB1120	131° 29' 32"	281.18	
NAL1101 to PNB1121	128° 35' 12"	273.14	
NAL1101 to PNB1122	126° 29' 42"	262.01	
NAL1101 to PNB1123	123° 50' 42"	251.41	
NAL1101 to PNB1124	120° 17' 42"	240.96	
NAL1101 to PNB1125	116° 42' 42"	219.72	
NAL1101 to PNB1126	112° 52' 52"	212.68	
NAL1101 to PNB1128	105° 48' 32"	187.18	
NAL1101 to PNB1129	100° 30' 02"	174.54	

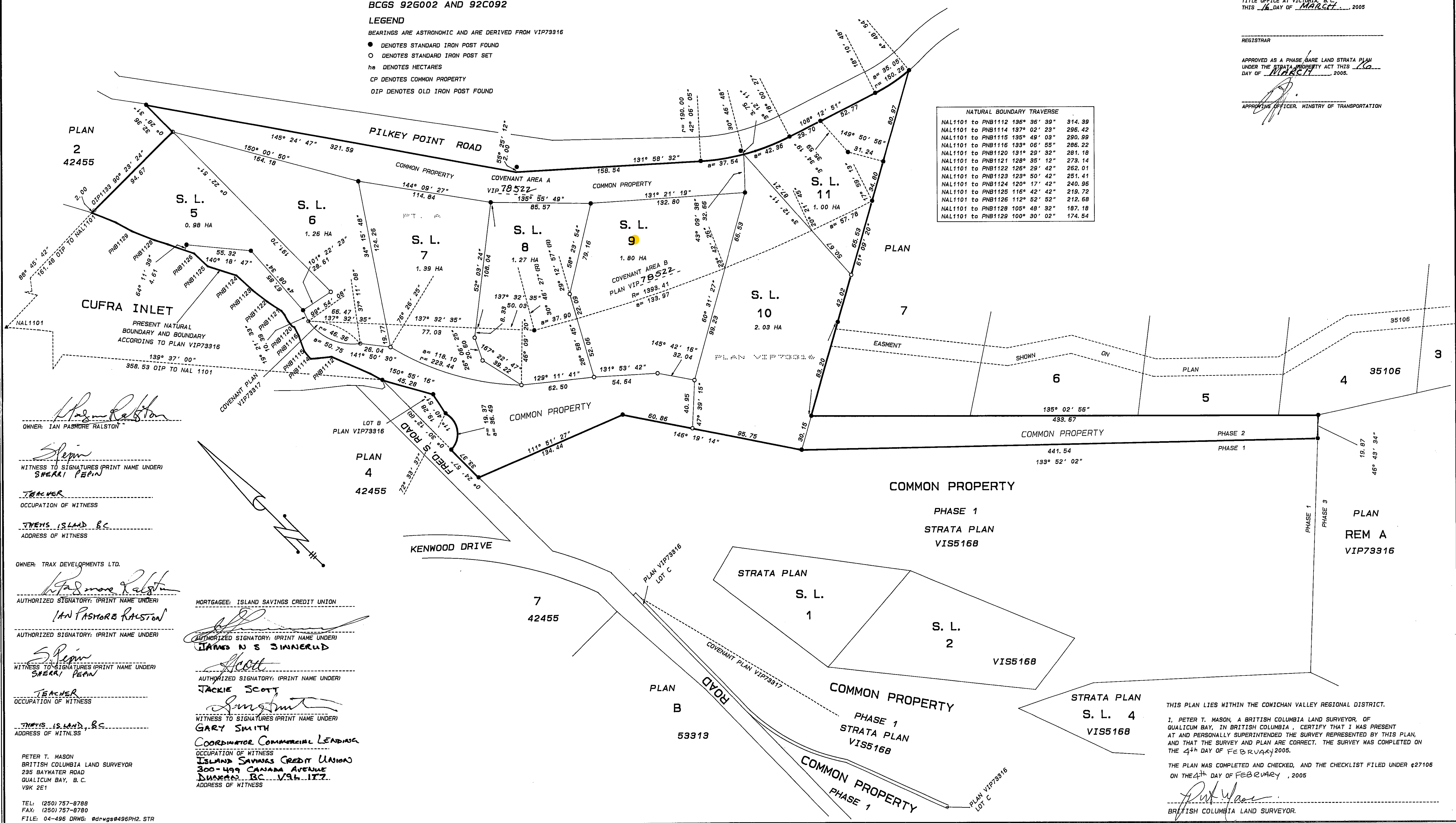

OWNER: IAN PASTORE RALSTON

WITNESS TO SIGNATURES (PRINT NAME UNDER)  
 SHERRI PEPIN

OCCUPATION OF WITNESS  
 T. MASON

ADDRESS OF WITNESS  
 THETIS ISLAND B.C.

OWNER: TRAX DEVELOPMENTS LTD.

AUTHORIZED SIGNATORY: (PRINT NAME UNDER)  
 IAN PASTORE RALSTON

AUTHORIZED SIGNATORY: (PRINT NAME UNDER)  
 SHERRI PEPIN

OCCUPATION OF WITNESS  
 T. MASON

ADDRESS OF WITNESS  
 THETIS ISLAND, B.C.

MORTGAGEE: ISLAND SAVINGS CREDIT UNION

AUTHORIZED SIGNATORY: (PRINT NAME UNDER)  
 JAMES N S SIMNERUD

AUTHORIZED SIGNATORY: (PRINT NAME UNDER)  
 JACKIE SCOTT

WITNESS TO SIGNATURES (PRINT NAME UNDER)  
 GARY SMITH

OCCUPATION OF WITNESS  
 COORDINATOR COMMERCIAL LENDING  
 ISLAND SAVINGS CREDIT UNION  
 300-499 CANADA AVENUE  
 DUNSMUIR, B.C. V9L 1T2

ADDRESS OF WITNESS

PETER T. MASON  
 BRITISH COLUMBIA LAND SURVEYOR  
 235 BAYWATER ROAD  
 QUALICUM BAY, B.C.  
 V9K 2E1

TEL: (250) 757-8788  
 FAX: (250) 757-8780  
 FILE: 04-496 DRWG: @drngs9496PH2. STR

THIS PLAN LIES WITHIN THE COWICHAN VALLEY REGIONAL DISTRICT.

I, PETER T. MASON, A BRITISH COLUMBIA LAND SURVEYOR, OF QUALICUM BAY, IN BRITISH COLUMBIA, CERTIFY THAT I WAS PRESENT AT AND PERSONALLY SUPERINTENDED THE SURVEY REPRESENTED BY THIS PLAN, AND THAT THE SURVEY AND PLAN ARE CORRECT. THE SURVEY WAS COMPLETED ON THE 4<sup>th</sup> DAY OF FEBRUARY 2005.

THE PLAN WAS COMPLETED AND CHECKED, AND THE CHECKLIST FILED UNDER #27106 ON THE 4<sup>th</sup> DAY OF FEBRUARY, 2005

Peter T. Mason  
 BRITISH COLUMBIA LAND SURVEYOR.